



**ROOF CURB - EXTENDED CABINET
50-65 TON OPEN CONDENSER END
MODEL# 026-36344-003**

INSTALLATION INSTRUCTIONS

New Release

Form: 100.50-N10 (1004)

This Roof Curb is NRCA approved and is constructed of 14 gauge galvanized steel with a full perimeter 2" X 4" wood nailer strip. The curb is shipped with the following parts:

026-36344-003 - 14" High		
Item	Qty	Description
A	2	End Panels - 83 x 14
B	6	Side Panels - 79 x 14
C	2	Side Panels - 45 x 14
D	6	Splice Channels
E	5	Brace Panels - 83 x 14
F	2	End Panels - 87 x 14
G	1	Hardware Package
	90	$\frac{3}{8}$ "-16 x 1.00 Hex Bolt w/ Nuts
	90	$\frac{3}{8}$ " Helical Lock Washers
	90	$\frac{3}{8}$ " Flat Washers
	112 ft	$\frac{3}{4}$ " x 1 $\frac{1}{4}$ " Foam Gasket

INSTALLATION

1. Layout the curb pieces as shown on Figure 1.
2. Install the $\frac{3}{8}$ " bolts on both ends of End Panel (A) and Brace Panel (E) through the designated holes in Side Panels (B). Make sure the corners are flush and square as shown in Figure 1. Tighten the hardware securely.

Place the curb in the proper location.

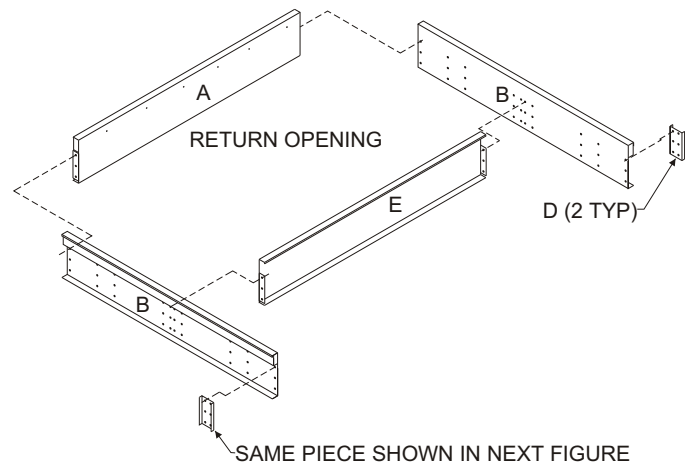

Figure 1

3. Layout the curb pieces as shown at the end of previous section.

4. Install the $\frac{3}{8}$ " bolts on both ends of Brace Panels (E) through the designated holes in Side Panels (B). Make sure the corners are flush and square as shown in Figure 2. Tighten the hardware securely.

Place the curb in the proper location.

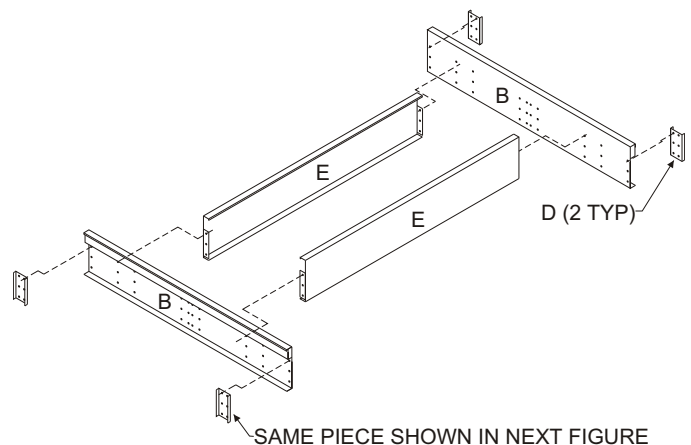
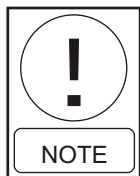
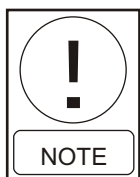

Figure 2



Make sure the curb section is "IN SQUARE".



Make sure the curb section is "IN SQUARE".

5. Layout the curb pieces as shown at the end of previous section.
6. Install the $\frac{3}{8}$ " bolts on both ends of Brace Panel (E) through the designated holes in Side Panels (B). Make sure the corners are flush and square as shown in Figure 3. Tighten the hardware securely.

Place the curb in the proper location.



Make sure the curb section is "IN SQUARE".

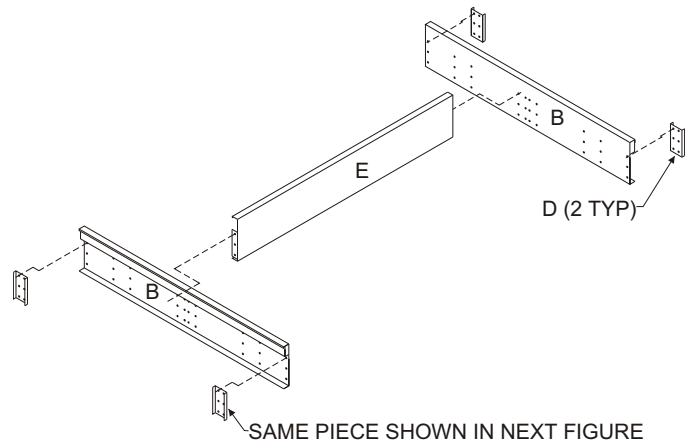

Figure 3

7. Layout the curb pieces as shown at the end of previous section.

8. Install the $\frac{3}{8}$ " bolts on both ends of Brace Panel (E) and End Panel (A) through the designated holes in Side Panels (C). Make sure the corners are flush and square as shown in Figure 4. Tighten the hardware securely.

Place the curb in the proper location.



Each section of the curbs is to be connected with the provided splice channels as shown in illustrations.

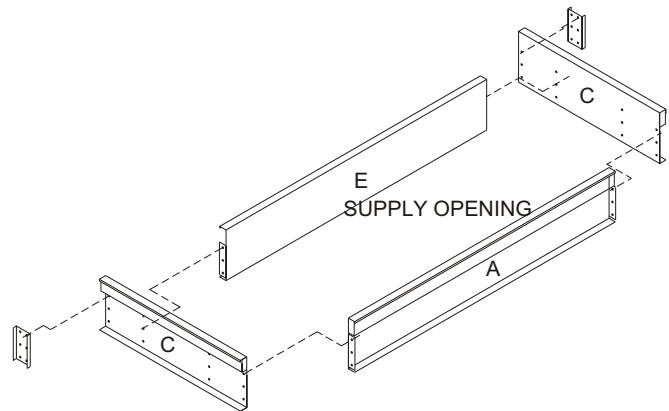

Figure 4

9. Take the two extra End Panels (F) and bolt back to back, then locate at the end of the condenser section, as shown in Figure 6.

10. Install $\frac{3}{4}$ " x $1 \frac{1}{4}$ " foam gasket on top of all curb surfaces as shown in Figure 5.

ROOF INSTRUCTIONS

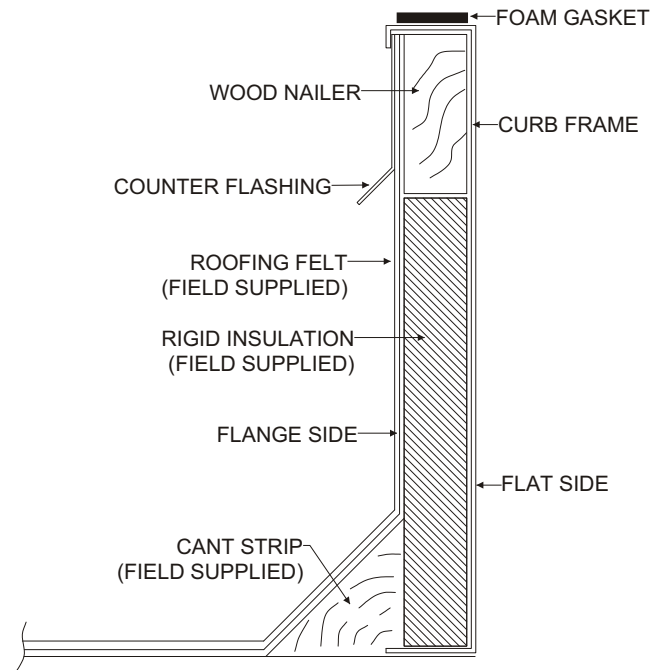

Figure 5

All dimensions are critical to ensure proper fit of the unit to the curb. All dimensions are from the "Flat Side" of the curb panels with the exception of "Outside" curb dimensions.

